

# specifications

## CC300-2SW

SKOPE Counterline - Slimline  
2 Door (Swing), Integral Fridge

### CABINET DIMENSIONS

	External	Internal
<b>Height:</b>	725mm*	545mm
<b>Width:</b>	1600mm	1120mm
<b>Depth:</b>	600mm	485mm
<b>Floor area:</b>	0.96m <sup>2</sup>	
<b>Gross volume</b>	335L	

\* Height excludes castors or legs

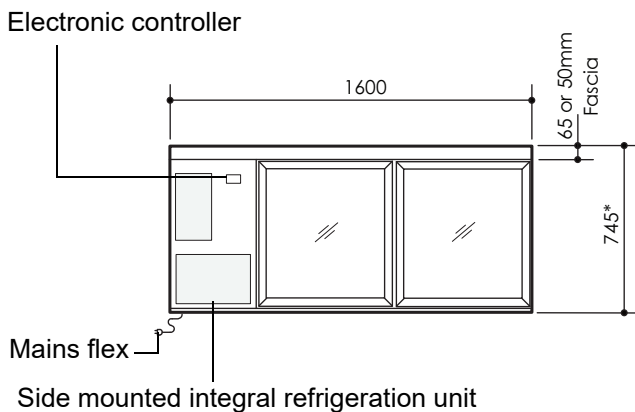
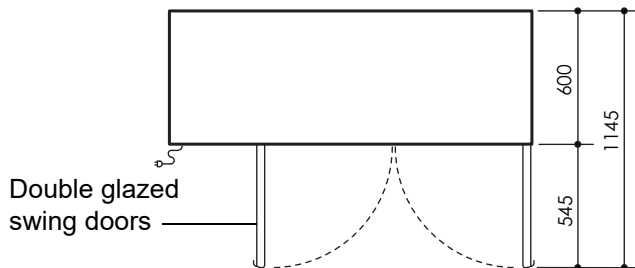

Optional  
Worktop

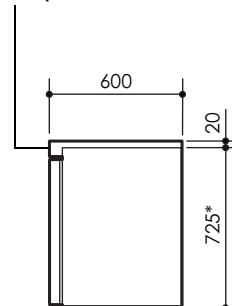

### CABINET SPECIFICATIONS

<b>Doors</b>	Self-closing, double glazed, toughened Low-E safety glass with aluminium extrusion or insulated solid doors
<b>Internal door opening size</b>	2 door openings: 544mm high x 520mm wide
<b>Shelves</b>	Adjustable height, white plastic coated, steel wire shelves - two per door
<b>Worktop (optional)</b>	Optional 20mm high stainless steel worktop with 65mm fascia
<b>Electrical safety climate class</b>	5
<b>Internal lighting</b>	1 x 20W T8 Frosted LED Tube (Ø26 x 900mm, 5500K) - Switched
<b>Electrical</b>	230-240 Volts a.c. 50 Hz, single phase supply, 2.3 Amps
<b>Temperature range</b>	+1°C to +4°C
<b>GEMS class</b>	M1
<b>GEMS energy consumption</b>	5.33 kWh/24h
<b>GEMS annual running cost</b>	\$584 p.a. (@ \$0.30/kWh)
<b>Refrigeration system</b>	Side mounted, integral refrigeration unit (UE12AAC-173ZC)
<b>Electronic controller</b>	SKOPE CAREL ir33
<b>Refrigerant</b>	R134a / 425 g
<b>Nominal capacity</b>	581 Watts
<b>Insulation</b>	50mm polyurethane foam
<b>Drainage</b>	No plumbing required

SKOPE Industries Limited reserve the right to alter specifications without notice. Copyright © 2007 SKOPE Industries Limited

PSS0067 Rev. 4.1 Mar. 2021

WA DEALER  
PRACTICAL PRODUCTS PTY LTD

PH: 08 9302 1299  
51 Paramount Dr Wangara WA 6065  
sales@practicalproducts.com.au  
www.practicalproducts.com.au