

# CHOCOLATE CASE

SCD-1200D

## FEATURES / BENEFITS

### ■ EXCEPTIONAL EXTERIOR AND SURFACE

It is designed with exceptional exterior and surface and demand of all users is matched. The glass is superclear and it can display properly.

### ■ DIGITAL CONTROL SYSTEM

Easy settings of operating mode, temperature and humidity.

### ■ HIGH-DENSITY POLYURETHANE INSULATION

The entire cabinet structure are foamed-in-place using high density, CFC free polyurethane insulation.

### ■ EFFICIENT REFRIGERATION SYSTEM

SKIPIO's refrigerators are designed with oversized and balanced (CFC Free R-134A) refrigeration systems. These include efficient evaporators and condensers for faster cooling and greater efficiency.

### ■ EFFICIENT REFRIGERATION SYSTEM

SKIPIO's refrigerators are designed with oversized and balanced refrigeration systems. These include efficient evaporators and condensers for faster cooling and greater efficiency.

### ■ FORCED AIR COOLING SYSTEM

Fast cooling and balanced temperature throughout the cabinet.

### ■ AIR FLOW GRILLE

Smooth air flow to maintain a consistent temperature, which is required for delicate food items. Fitted with LED lights to showcase your food products for high visibility.

### ■ LED INTERIOR LIGHTING BLOW

Bright LED interior lighting is specifically designed blow for perfect visibility.



Model	# of Drawers	Doors	Capacity (Liters)	Compressor (HP)	Amps (A)	Weight (Kg)	L X D X H (mm)
SCD-1200D	2	1	108	1/3	2.5	190	1200x800x945

# CHOCOLATE CASE

SCD-1200D

*Model: SCD-1200D*

SPEC SHEET	SCD-1200D
Classification	Refrigerator
Cabinet Dimension (WxDxH mm)	1200x800x945
Capacity (Liters)	108
Inner Temperature	3°C~8°C / 10°C~14°C
# of Drawers	2
Doors	1
Refrigerant	R-134a
Compressor (Hp)	1/3
Lamp	LED lamp
Cooling Type	Fan cooling type
Insulation Type	Polyurethane / Cyclopentane + CFC Free
Temperature Control Type	Digital
Amps (A)	2.5
Voltage (V/Hz/Ph)	240V 50Hz 1Ph
Weight (Kg)	190

**PLAN VIEW** (unit: mm)

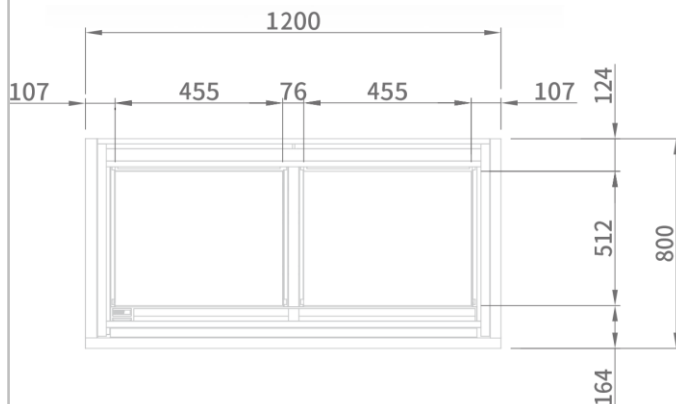

**FRONT VIEW**

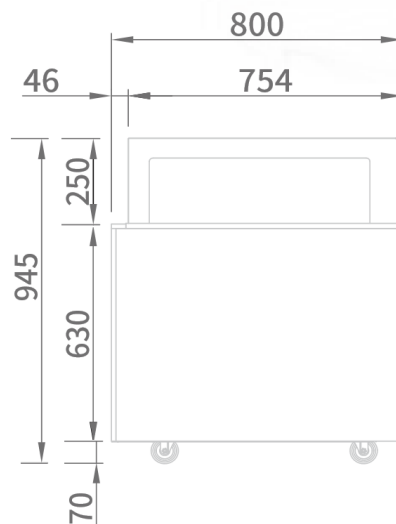

**SIDE VIEW**

**WARRANTY** **2 YEARS**  
PARTS & LABOUR