

Proveno 4G Electric Combi Jacketed Kettle

Proveno 4G Combi 200E (4224310)

Standard Features

- Proven kettle with integrated mixer
- Electric heated version
- Stepless mixing speed 15-140 rpm/min, auto-reverse
- Elevated control pillar with guiding touch panel
- Safety grid lid
- Audiovisual signals for user
- Multi-function timer
- ProTemp – real time temperature control, food and jacket temperature separately controlled
- Delta T cooking – temperature of jacket rises accordingly when food temperature rises
- Programming on screen, unlimited number of programs and program phases, favourite pages, wash programs
- Automatic measured water filling
- Electric tilting - tilting height 600mm
- Tilting while mixing function
- Auto tilt-back
- Measuring stick
- Retractable handshower
- Strainer plate
- USB Port on control panel
- Diagnostics for maintenance
- Unit shown includes free standing floor kit - other options available

Please refer to Moffat price list for options and accessories

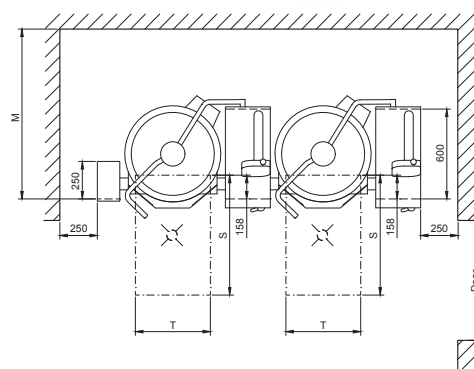
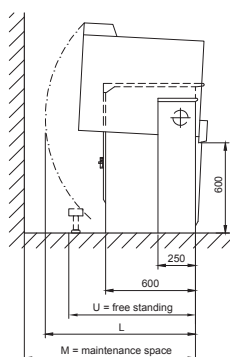
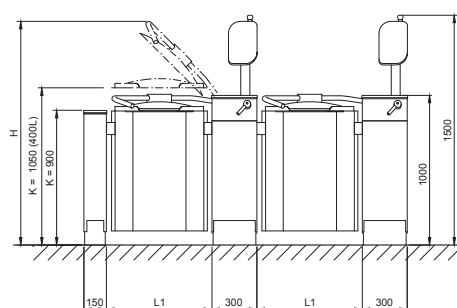

Technical Data

Net Volume 200 L

Spare Volume 19 L

Gross Volume 219 L

Dimensions

Width 1360mm

Width	1830mm
Height	1535mm

Depth 969mm

Connections

Water Cold ø15mm

Hot $\varnothing 15\text{mm}$

Electrical

Power 35.6 kW
Voltage 400-415V,
3P+N+E 50/60Hz
AMP 63A

34kW

Total Heat

Latent 1.4 kW,
Sensible 6.1 kW

Waste

By kitchen contractor

Nett Weight

345 kg

Model	L1 mm	H mm	L mm	M mm	U mm	T mm	Door mm
200E	910	1945	1155	1285	1110	600	1000



WA DEALER
PRACTICAL PRODUCTS PTY LTD

PH: 08 9302 1299

51 Paramount Dr Wangara WA 6065

sales@practicalproducts.com.au

www.practicalproducts.com.au