

Viking 4G Electric Mixing Bratt Pan

Viking 4G Mix Pan 150E (4224260)

Standard Features

- High temperature mixing pan with integrated mixer
- 150 litre capacity
- Electric heated version
- Elevated control pillar with selected features
- Electromechanical controls
- Temperature control between 50°C - 250°C
- Stepless mixing speed 15-40 rpm/min
- Two mixing programs with autoreverse
- Electric tilting - tilting height 600mm
- Safety grid lid
- Removable mixer with three mixing arms
- Food grade thermopolymer scrapers for mixing tool
- Retractable handshower
- Water filling inlet
- Stainless steel construction
- Free standing frame with feet
- Group installation option available

Please refer to Moffat price list for options and accessories

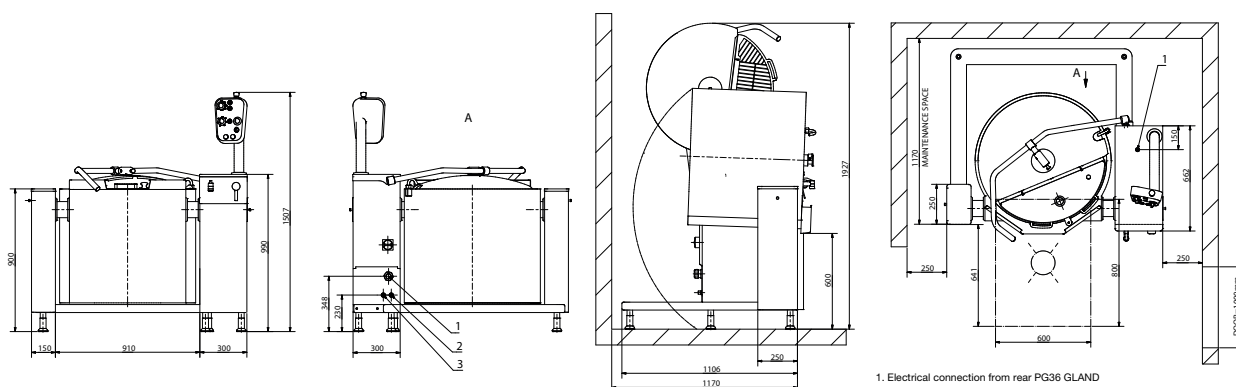

Technical Data

Net Volume 150 L
Frying surface 0.59m²

Dimensions

Width 1360mm
Height 1507mm
Depth 1170mm

Connections

Water Cold ø15mm
Hot ø15mm

Electrical

Power 26.2 kW
Voltage 400-415V,
3P+N+E 50/60Hz
AMP 43.7A

Total Heat

20 kW

Load

Latent 1.0 kW,
Sensible 4.3 kW

Waste

By kitchen
contractor

Nett Weight

373 kg

1. Electrical connection from rear PG36 GLAND
2. Cold water connection R1/2" (ø15), to be fitted with non-return valve and shut off valve
3. Hot water connection R1/2" (ø15), to be fitted with non-return valve and shut off valve (option)



WA DEALER
PRACTICAL PRODUCTS PTY LTD

PH: 08 9302 1299
51 Paramount Dr Wangara WA 6065
sales@practicalproducts.com.au
www.practicalproducts.com.au