



800 SERIES GRIDDLE PLATE

20 mm plate



GPGDB48 – Gas

- 20 mm thick Mild Steel Plate maximizes greater heat retention for consistent cooking
- Front grease trough, generous chute and catcher
- Stainless Steel fascia and sides, spill zone and grease can for ease of cleaning

Other options

Machined steel or ribbed plates

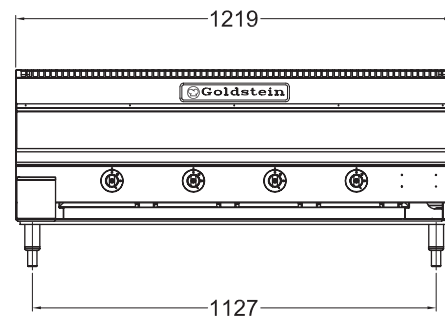
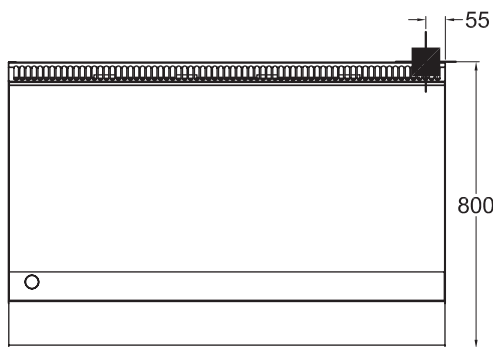
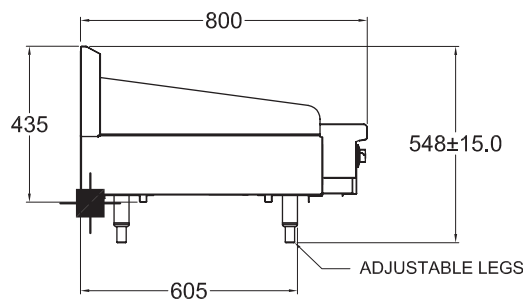

GPGDB48

SPECIFICATIONS

Dimensions (WxDxH)	1220 x 800 x 550 mm
Plate size (WxDxH)	1220 x 520 x 20 mm
Gas connection	3/4" BSP

3/4" BSP Gas Connection

Rating	80 Mj
Weight	220 kg
Packed	0.5 m ³

WA DEALER
PRACTICAL PRODUCTS PTY LTD

PH: 08 9302 1299
51 Paramount Dr Wangara WA 6065
sales@practicalproducts.com.au
www.practicalproducts.com.au

