



Bottom Mount, 1 Glass Door, Upright Fridge

Range: EziCore

SKOPE ID: EB60BYN

Dimensions: 740 mm (W) × 795 mm (D) × 2205 mm (H)

Capacity: 559 L

Project: _____

Item #: _____



A high-efficiency, bottom-mounted, one glass door display fridge designed to display and store ready-to-serve chilled food and drinks. Suitable for a range of front of house applications such as bars, restaurants, clubs, pubs, cafés, convenience stores, supermarkets, and quick service restaurants. It is engineered to serve cold drinks at 0°C to 5°C in ambient environments of up to 35°C and is GEMS-compliant as well as food-safe with 3M1 climate class. The fridge is made from powder-coated, galvanised steel with black exterior and white interior, and you can customise the lit sign panel with your own branding. The double-glazed door helps prevent condensation and includes built-in LED lights in the door frame to ensure excellent merchandising of your products. The self-contained fridge uses R290 natural refrigerant for ultra-low energy consumption, low heat discharge and low noise output. The bottom-mounted refrigeration cartridge can be removed in line with best practice for safe servicing of flammable refrigerants. The fridge is certified to all Australian and New Zealand refrigeration and electrical safety standards.



Warranty



Natural Refrigerant



GEMS



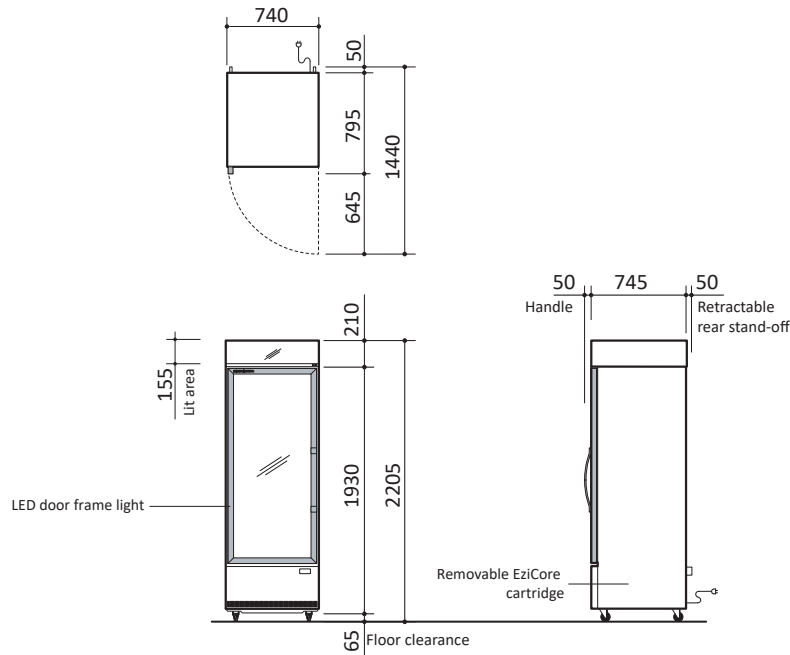

Cabinet

Type	BCE Fridge		
Finish	Powdercoated galvanised steel		
Insulation	Type	PU foam	
	Thickness (mm)	50	
	Blowing Agent	Cyclo-iso pentane (C5H10/C5H12)	
Doors	Type	Glass swing door (double-glazed, argon-filled, toughened safety glass)	
	Opening Size	Height (mm)	1455
		Width (mm)	640
Shelving	Five adjustable height, full width shelves 4 x plastic-coated wire shelf (620W x 505D), 1 x powdercoated galvanised steel shelf (625W x 515D)		
Lighting	Sign	1 x 3 W, 490 mm LED	
	Interior	2 x 6 W, 1360 mm LED in door frame	

Dimensions†

	External	Internal	Packed
Width (mm)	740	640	755
Depth (mm)	795	600	820
Height (mm)	2205 (castors)	1455	2205
Weight (kg)	148.2		153.2
Capacity (L)	559		
Footprint (m²)	0.59		

Ventilation (mm)

Top	50	Sides	Not required	Rear	50
------------	----	--------------	--------------	-------------	----

Dimensional Tolerances

† Allow for dimensional tolerances when installing the cabinet(s).

Linear dimensions	Single cabinet	Multiple cabinets	
		At each joint	At each end wall
Less than 1 metre	±5 mm	±5 mm	+15 mm
More than 1 metre	-5 mm to +10 mm	-5 mm to +10 mm	+15 mm

Performance

Product Temperature Range (°C)	0 to +5
Maximum Ambient Temperature (°C)	35
Sound Level (dB(A))	Standard <65

Greenhouse and Energy Minimum Standards (GEMS)

Star Rating	8
Product Temperature Class	M1 (-1 to 5°C)
Total Energy Consumption	3.04 kWh/24 h
Annual Running Costs	\$333 (@ \$0.30/kWh)

Electrical

Supply	220-240 volts a.c., 50 Hz, single phase supply
Cord	2 m power cord with 3-pin, 10 amp plug
Current draw (A)	3.0

Refrigeration

Controller	Electronic – adjustable
System Type	Removable cartridge
Cartridge Weight (kg)	25.6
Refrigerant/Charge	R290/84 g
Nominal Capacity (W)	670 (EN12900 MBP)
Heat Rejection (W)	Average 125 Peak 140
Defrost Type	Automatic, off-cycle
Drainage	No plumbing required



WA DEALER
PRACTICAL PRODUCTS PTY LTD

PH: 08 9302 1299
51 Paramount Dr Wangara WA 6065
sales@practicalproducts.com.au
www.practicalproducts.com.au