

## Top Mount, 2 Glass Door, Upright Fridge



Range: EziCore

SKOPE ID: ET10BYN

Dimensions: 1130 mm (W) × 750 mm (D) × 2210 mm (H)

Capacity: 896 L

Project: \_\_\_\_\_

Item #: \_\_\_\_\_



A high-efficiency, top-mounted, two glass door display fridge designed to display and store ready-to-serve chilled food and drinks. It is suitable for a range of front of house applications such as bars, restaurants, clubs, pubs, cafés, convenience stores, supermarkets, and quick service restaurants. The fridge is engineered to serve cold drinks at 0°C to 5°C in ambient environments of up to 35°C and is GEMS-compliant as well as food-safe with 3M1 climate class. It is made from white powder-coated, galvanised steel, and you can customise the lit sign panel with your own branding. The double-glazed door helps prevent condensation and includes built-in LED lights in the door frame to ensure excellent merchandising of your products. The self-contained fridge uses R290 natural refrigerant for ultra-low energy consumption, low heat discharge and low noise output. The top-mounted refrigeration cartridge can be removed in line with best practice for safe servicing of flammable refrigerants. The fridge is certified to all Australian and New Zealand refrigeration and electrical safety standards.



Warranty



Natural Refrigerant



GEMS

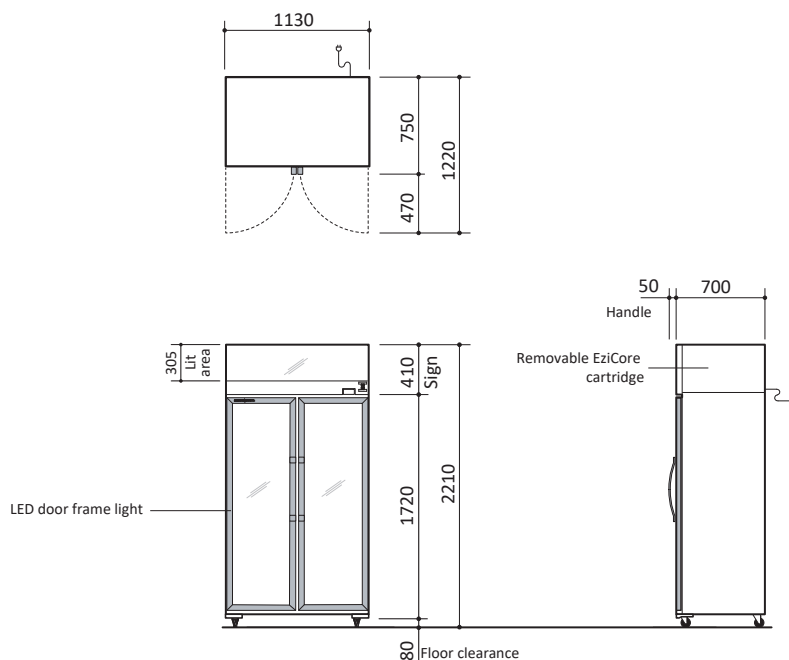

**Cabinet**

<b>Type</b>	TCE Fridge		
<b>Finish</b>	Powdercoated galvanised steel		
<b>Insulation</b>	Type	PU foam	
	Thickness (mm)	50	
	Blowing Agent	Cyclo-iso pentane (C5H10/C5H12)	
<b>Doors</b>	Type	Glass swing door (double-glazed, argon-filled, toughened safety glass)	
	Opening Size	Height (mm)	1570
		Width (mm)	465
<b>Shelving</b>	Four adjustable height plastic-coated wire shelves 4 x full width shelf (1005W x 460D)		
<b>Lighting</b>	Sign	2 x 3 W, 490 mm LED	
	Interior	4 x 6 W, 1360 mm LED in door frame	

**Dimensions†**

	External	Internal	Packed
<b>Width (mm)</b>	1130	1030	1145
<b>Depth (mm)</b>	750	554	775
<b>Height (mm)</b>	2210 (castors)	1570	2210
<b>Weight (kg)</b>	187		191
<b>Capacity (L)</b>	896		
<b>Footprint (m²)</b>	0.85		

**Ventilation (mm)**

Top	300	Sides	Not required	Rear	Not required
-----	-----	-------	--------------	------	--------------

**Performance**

<b>Product Temperature Range (°C)</b>	0 to +5
<b>Maximum Ambient Temperature (°C)</b>	35
<b>Sound Level (dB(A))</b>	Standard <65

**Greenhouse and Energy Minimum Standards (GEMS)**

<b>Star Rating</b>	7
<b>Product Temperature Class</b>	M1 (-1 to 5°C)
<b>Total Energy Consumption</b>	4.77 kWh/24 h
<b>Annual Running Costs</b>	\$522 (@ \$0.30/kWh)

**Electrical**

<b>Supply</b>	220-240 volts a.c., 50 Hz, single phase supply
<b>Cord</b>	2.3 m power cord with 3-pin, 10 amp plug
<b>Current draw (A)</b>	3.0

**Refrigeration**

<b>Controller</b>	Electronic – adjustable		
<b>System Type</b>	Removable cartridge		
<b>Cartridge Weight (kg)</b>	25.6		
<b>Refrigerant/Charge</b>	R290/84 g		
<b>Nominal Capacity (W)</b>	670 (EN12900 MBP)		
<b>Heat Rejection (W)</b>	Average	200	Peak 225
<b>Defrost Type</b>	Automatic, off-cycle		
<b>Drainage</b>	No plumbing required		

**Dimensional Tolerances**

† Allow for dimensional tolerances when installing the cabinet(s).

Linear dimensions	Single cabinet	Multiple cabinets	
		At each joint	At each end wall
Less than 1 metre	±5 mm	±5 mm	+15 mm
More than 1 metre	-5 mm to +10 mm	-5 mm to +10 mm	+15 mm

**WA DEALER**  
**PRACTICAL PRODUCTS PTY LTD**

PH: 08 9302 1299  
51 Paramount Dr Wangara WA 6065  
sales@practicalproducts.com.au  
www.practicalproducts.com.au