

# HB2U

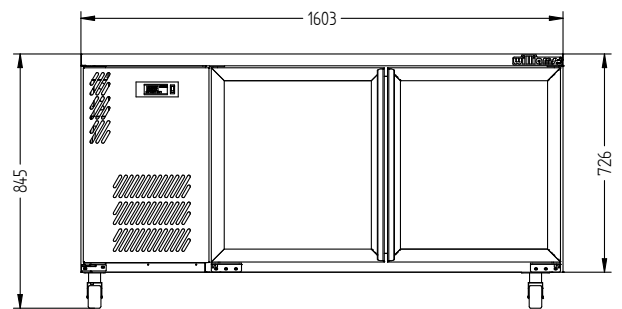

CATEGORY	GENERAL COUNTERS & BACK BARS
RANGE	<b>BORONIA</b>
UNIT	REFRIGERATOR
TYPE	SELF CONTAINED
DOORS	2

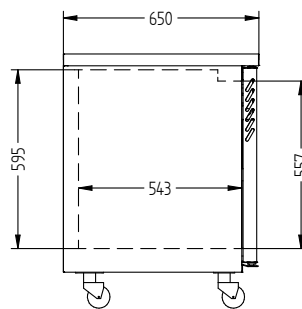
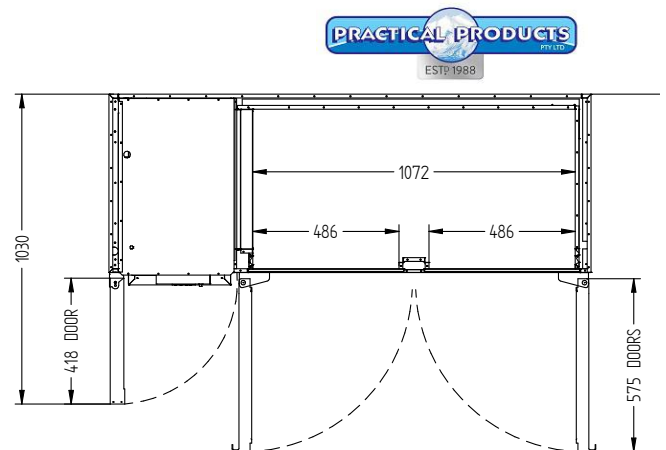

## SPECIFICATIONS

CAPACITY LITRES	360
TEMPERATURE	1°C / 4°C
FRONT BREATHING	YES
DIMENSIONS - W X D X H (ON CASTORS) MM	1603 W x 650 D x 845 H
WEIGHT UNPACKED (KG)	130

## STANDARD INCLUSIONS \*\*\*

DOOR TYPE	Standard: G (Glass Door) Optional: S (Solid Door)
FINISH	B (Black with stainless steel countertop and internal floor) or S (Stainless Steel) interior and exterior excluding rear and under
SHELVES/DOOR	2

## ELECTRICAL

POWER SUPPLY		10 amp
FRIDGE MODELS	RUNNING AMPS	3

## GAS TYPE

REFRIGERANT	FRIDGE MODELS	R134a
-------------	---------------	-------



**WA DEALER**  
**PRACTICAL PRODUCTS PTY LTD**

PH: 08 9302 1299  
51 Paramount Dr Wangara WA 6065  
sales@practicalproducts.com.au  
www.practicalproducts.com.au